

51-55 Chevy Truck No Vent (for one piece glass)

Right Side

\*kit uses 47-50 regulators

1. Use the template provided and bolt it up to the armrest holes.
2. Drill the 5 holes in the door using template to locate. This will provide regulator and idler bar mounting holes. Motor can be removed to get regulator into door.
3. Mark a square line from the front lower corner of window opening down the front edge of door.
4. Drill  $\frac{1}{4}$ " hole for vertical channel  $3\frac{3}{4}$ " from edge of door and centered between the two ribs.
5. Bolt vertical channel in place at the bottom keeping it square to the line you've drawn.
6. Attach vertical channel at the top either by gluing or screwing it in. It does not need much support at the top.
7. Vertical channel should run parallel to the factory rear channel.
8. Lower glass channel will attach to glass with the long end to the front of the door.

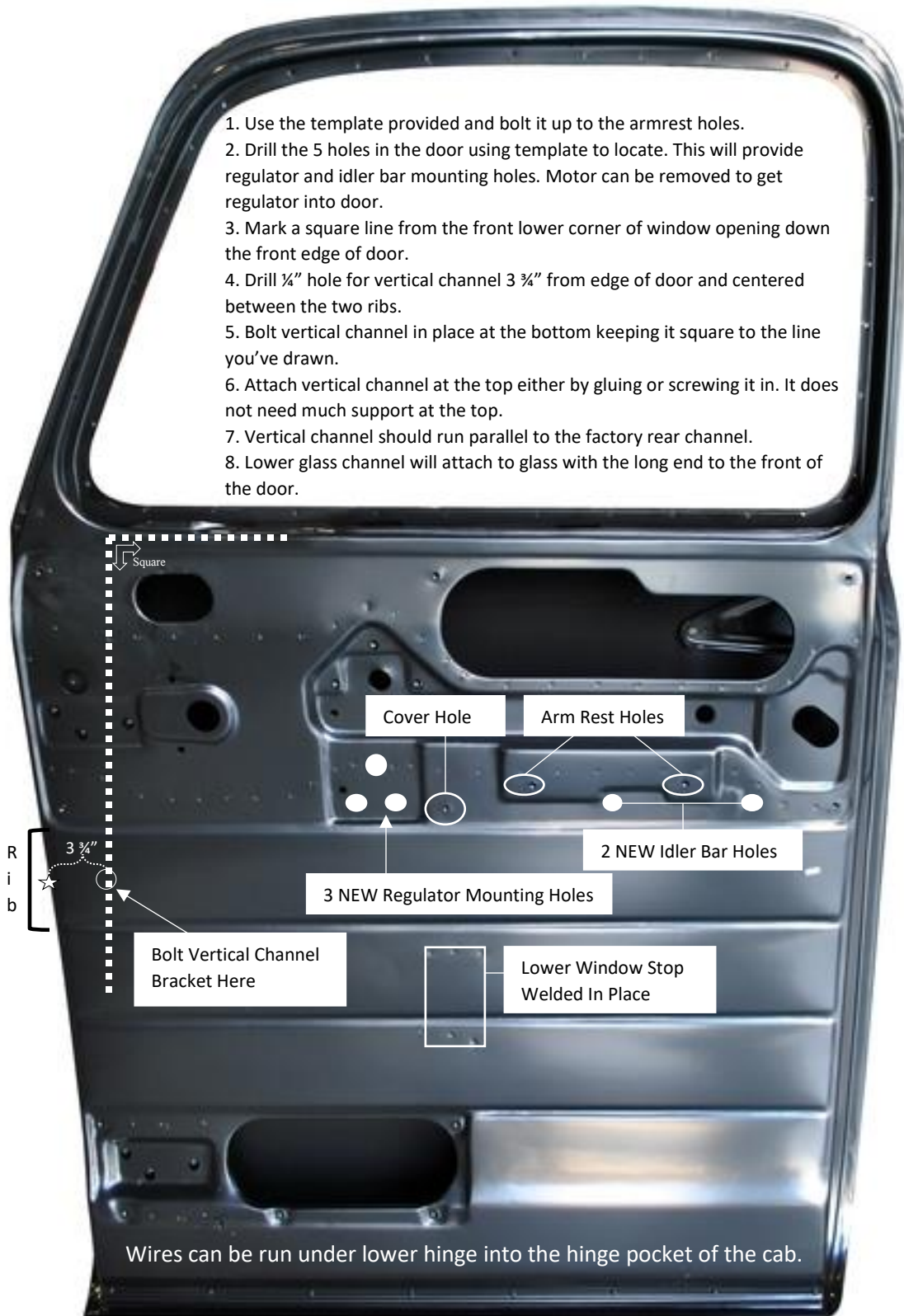

Wires can be run under lower hinge into the hinge pocket of the cab.